



**HIGH QUALITY THIN  
SCREED FOR BONDED  
AND UNBONDED  
APPLICATIONS**



**TS-20 DATASHEET**

# TS-20 DATASHEET



## Description

GYPSOL TS-20 screed is a revolutionary new anhydrite screed material. It is specially formulated to offer a strong and durable thin topping to a solid interior substrate, for example, in situ concrete or beam and block or precast concrete plank. Tested to BS8204:1:2003 it meets the requirements for class A for impact resistance. Due to its thin depth, just 20mm minimum, TS-20 can be dried quickly allowing rapid return to service and application of finished floor coverings.

Gypsol TS-20 is perfectly suited to flooring applications where height is extremely restricted and offers a lightweight cost effective alternative to smoothing compounds. It can be installed extremely quickly to at least 2000m<sup>2</sup> per day. This represents a significant saving in time when compared to bagged, site mixed smoothing compounds and levelling screeds.

Gypsol TS-20 screed is designed to be laid to a minimum of 20mm depth and can be used either bonded directly to a solid substrate prepared in accordance with BS8204:7:2003 or un-bonded on a polythene membrane.

For project specific advice on design and for a model specification, contact our technical and specifications team on 01928 574574

Some typical applications include:

- Refurbishment of old uneven floors.
- Remediation or correction for out of level concrete slabs
- As a levelling screed over floors where floor height is restricted.
- Sub floor levelling in preparation to receive finished floor coverings.
- Overlay for poorly levelled screeds
- As an overlay to an electric underfloor heating system
- As an alternative to light weight screeds

## PHYSICAL DATA

Appearance	Off white fluid mortar
Density	Wet 2200kg/m <sup>3</sup> Dry 2000kg/m <sup>3</sup>
Typical Strength (28 days) N/mm <sup>2</sup>	C30-F5
Required Flow (EN 13454-2)	230mm to 270mm
Reaction to fire	Class A1 <sub>fl</sub> non combustible

## PERFORMANCE DATA

Working Time	Place within 2 hours of batching Finish within 1 hour of placing
Foot Traffic	24 to 48 hours
Loading	5 to 7 days
Drying Time (20°C/60% RH)	in excess of 1mm/day
Force Drying	Can be force dried after 7 days
Minimum Depth	20mm

## TYPICAL APPLICATION SCHEMATIC

### TS-20 Screed laid Un-Bonded

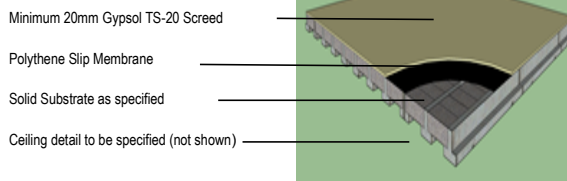

Commented [AJ1]:

Commented [AJ2R1]:

## ENVIRONMENTAL DATA

Recycled content	Binder 98% Mortar up to 40%
Carbon Emissions	Binder 10 to 20kg per tonne Mortar 20 to 40kg per m <sup>3</sup>
VOC	Virtually Zero
Recyclability	100%

## HEALTH AND SAFETY DATA

Gypsol TS-20 screed is delivered to site ready to use via offsite mixing plants eliminating the need for labour intensive site mixing and associated mixing equipment.

Gypsol TS-20 screed is pumped directly to where it is needed, eliminating much of the manual handling operations required to install other screeds.

Gypsol TS-20 screed is generally pumped using equipment with closed or grilled dispensing hoppers, removing risk of contact with moving machinery.

Gypsol TS-20 screed is finished using a lightweight dapping bar requiring no secondary compaction, thus removing most of the physical work needed to lay other screeds. This significantly reduces the negative impact on the musculoskeletal system of installing contractors. For material safety information please see the relevant health and safety data sheets.

A Division of  
**FRANCIS FLOWER**



t: 01928 574574  
e: ff@francisflower.co.uk w:  
www.gypsol.co.uk

issue 1:  
February 23, 2015